



MITSUBISHI ELECTRIC
General-Purpose AC Servo
MELSERVO
EXTENSION I/O UNIT
MR-J3-D01
INSTALLATION GUIDE

Country/Region	Sales office	Tel/Fax
USA	MITSUBISHI ELECTRIC AUTOMATION, INC. 500 Corporate Woods Parkway, Vernon Hills, IL 60061, U.S.A.	Tel: +1-847-478-2100 Fax: +1-847-478-2283
Mexico	MITSUBISHI ELECTRIC AUTOMATION, INC. Mexico Branch Mariano Escobedo #69, Col.Zona Industrial, Tlalrepanita Edo, C.P.54030, México	Tel: +52-55-9171-7600 Fax: +52-55-9171-7649
Brazil	MITSUBISHI ELECTRIC DO BRASIL COMERCIO E SERVIÇOS LTDA Rua Assis Brasil, 1750 - Bloco 3 - Anexo, Jardim Santa Cecilia, CEP 06485-070, Barueri - SP, Brazil	Tel: +55-11-4689-3000 Fax: +55-11-4689-3016
Germany	MITSUBISHI ELECTRIC EUROPE B.V. German Branch Gothar Strasse 8, D-40880 Ratingen, Germany	Tel: +49-2102-486-0 Fax: +49-2102-486-1120
UK	MITSUBISHI ELECTRIC EUROPE B.V. UK Branch Travellers Lane, Hatfield, Hertfordshire, AL10 8XB, U.K.	Tel: +44-1707-28-8780 Fax: +44-1707-27-8695
Italy	MITSUBISHI ELECTRIC EUROPE B.V. Italian Branch Centro Dinezzone Coltoni - Palazzo Siro Viale Colleoni 7, 20864 Agrate Brianza(Milano) Italy	Tel: +39-039-60531 Fax: +39-039-6053-312
Spain	MITSUBISHI ELECTRIC EUROPE B.V. Spanish Branch Carretera de Rubí, 76-80-Appdo. 428, 08173 Sant Cugat del Valles (Barcelona), Spain	Tel: +34-935-65-3131 Fax: +34-935-89-1579
France	MITSUBISHI ELECTRIC EUROPE B.V. French Branch 25, Boulevard des Bouvets, F-92741 Nanterre Cedex, France	Tel: +33-1-55-68-55-68 Fax: +33-1-55-68-57-57
Czech Republic	MITSUBISHI ELECTRIC EUROPE B.V. Czech Branch Svatoplukova 50, 32-083 Balice, Poland	Tel: +42-251-551-470 Fax: +42-251-551-471
Poland	MITSUBISHI ELECTRIC EUROPE B.V. Polish Branch ul. Krakowska 50, 32-083 Balice, Poland	Tel: +48-12-630-47-00 Fax: +48-12-630-47-01
Russia	MITSUBISHI ELECTRIC EUROPE B.V. Russian Branch St. Petersburg office Piskarevsky pr. 2, bld 2, lit "Sch", BC "Benua", office 720; RU-195027 St. Petersburg, Russia	Tel: +7-812-633-3497 Fax: +7-812-633-3499
Turkey	MITSUBISHI ELECTRIC TURKEY A.S. Umraniye Branch Sarıdal Mahallesi Nispetiye Sokak No:311R-34773 Umraniye, Istanbul, Turkey	Tel: +90-216-526-3990 Fax: +90-216-526-3995
South Africa	ADROIT TECHNOLOGIES 20 Waterford Office Park, 189 Wilkoppen Road, ZA-Fourways, South Africa	Tel: +27-11-658-8100 Fax: +27-11-658-8101
China	MITSUBISHI ELECTRIC AUTOMATION (CHINA) LTD. No.1386 Hongqiao Road, Mitsubishi Electric Automation Center, Changning District, Shanghai, China	Tel: +86-21-2322-3030 Fax: +86-21-2322-3000
Taiwan	SETSUYO ENTERPRISE CO., LTD. 6F, No.105, Wugong 3rd Road, Wugu District, New Taipei City 24889, Taiwan, R.O.C.	Tel: +886-2-2299-2499 Fax: +886-2-2299-2509
Korea	MITSUBISHI ELECTRIC AUTOMATION KOREA CO., LTD. 1490-6, Gayang-Dong, Gangseo-Gu, Seoul, 157-200, Korea	Tel: +82-2-3690-9510 Fax: +82-2-3694-8372/8335
Singapore	MITSUBISHI ELECTRIC ASIA PTE. LTD. 307, Alexandra Road, Mitsubishi Electric Building, Singapore 159943	Tel: +65-6473-2308 Fax: +65-6476-7439
Thailand	MITSUBISHI ELECTRIC FACTORY AUTOMATION (THAILAND) CO., LTD. 12th Floor, SV City Building, Office Tower 1, No. 999/19 and 20 Rama 3 Road, Kwaeng Bangpoo, Khet Yankin, Bangkok 10120, Thailand	Tel: +66-2682-6522 to 6531 Fax: +66-2682-6020
Indonesia	PT. MITSUBISHI ELECTRIC INDONESIA Gedung Jaya 11th Floor, J.L. MH. Thamrin No.12, Jakarta Pusat 10340, Indonesia	Tel: +62-21-3192-4461 Fax: +62-21-3192-3942
Vietnam	MITSUBISHI ELECTRIC VIETNAM COMPANY LIMITED Unit 01 - 04, 10th Floor, Vincom Center, 72 Le Thanh Ton Street, District 1, Ho Chi Minh City, Vietnam	Tel: +84-8-3910-5945 Fax: +84-8-3910-5947
India	MITSUBISHI ELECTRIC INDIA PVT. LTD. Pune Branch Emerald House, EL-3, J Block, M.I.D.C., Bhosari, Pune, 411026, Maharashtra Strta, India	Tel: +91-20-2710-2000 Fax: +91-20-2710-2100
Australia	MITSUBISHI ELECTRIC AUSTRALIA PTY. LTD. 348 Victoria Road, P.O. Box 11, Rydalmere, N.S.W. 2116, Australia	Tel: +61-2-9684-7777 Fax: +61-2-9684-7245

MITSUBISHI ELECTRIC CORPORATION

HEAD OFFICE: TOKYO BLDG MARUNOUCHI TOKYO 100-8310

This guide uses recycled paper.
Specifications are subject to change without notice.

IB(NA)0300120-C(1403)MEE Printed in Japan

Copyright © 2014 Mitsubishi Electric Corporation All Right Reserved.

Rating plate
The following shows an example of rating plate for explanation of each item.

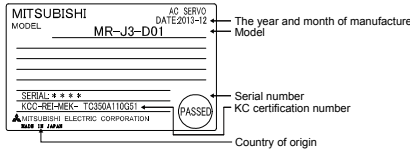

1. About this installation guide

1.1 Manual
This installation guide explains how to mount MR-J3-D01. If you have any questions about the operation of the equipment described in this guide, contact your local sales office. In addition, when you mount a protective device, specific technical skills which are not detailed in the guide will be required.

1.2 Purpose of this guide
This installation guide explains for engineers of machinery manufacturers and machine operators. For details of servo amplifiers on which MR-J3-D01 is mounted, refer to each instruction manual or specification of the servo amplifiers.

2. About safety

This chapter explains safety of users and machine operators. Please read the chapter carefully before mounting the equipment. In this installation guide, the specific warnings and cautions levels are classified as follows.

WARNING Indicates that incorrect handling may cause hazardous conditions, resulting in death or severe injury.

CAUTION Indicates that incorrect handling may cause hazardous conditions, resulting in medium or slight injury to personnel or may cause physical damage.

2.1 Professional engineer
Only professional engineers should mount MR-J3-D01. Here, professional engineers are persons who have taken proper engineering training. Check if applicable technical training is available at your local Mitsubishi Electric office. Contact your local sales office for schedules and locations.

2.2 Correct use
Always use MR-J3-D01 within specifications (voltage, temperature, etc. Refer to chapter 7 of this installation guide for details.). Mitsubishi Electric Co. accepts no claims for liability if the equipment is used in any other way or if modifications are made to the device, even in the context of mounting and installation.

2.2.1 Selection of peripheral equipment and wire
For details of MCCB, fuses, and wire selections of servo amplifiers on which MR-J3-D01 is mounted, refer to each instruction manual or specification of the servo amplifiers. MR-J3-D01 has a part for grounding on the frame (FG). Fix the metal part FG of MR-J3-D01 with a screw to ground.

2.2.2 EU compliance
The servo amplifiers on which MR-J3-D01 is mounted are designed to comply with the following directions to meet requirements for mounting, using, and periodic technical inspections: EMC directive (2004/108/EC) and Low-voltage directive (2006/95/EC).

- (1) EMC requirement
The servo amplifiers on which MR-J3-D01 is mounted comply with category C3 in accordance with IEC/EN 61800-3. As for I/O wires (max. length 10 m) and encoder cables (max. length 50 m), use shielded wires and ground the shields. Use an EMC filter and surge protector on the primary side. The following shows recommended products. EMC filter: Soshin Electric HF3000A-UN series
Surge protector: Okaya Electric Industries RSPD-250-U4 series
- MELSERVO Series are not intended to be used on a low-voltage public network which supplies domestic premises;
- radio frequency interference is expected if used on such a network.
The installer shall provide a guide for installation and use, including recommended mitigation devices.

(2) For Declaration of Conformity (DoC)
Hereby, MITSUBISHI ELECTRIC EUROPE B.V., declares that the servo amplifiers are in compliance with the necessary requirements and standards (2004/108/EC and 2006/95/EC). For the copy of Declaration of Conformity, contact your local sales office.

2.2.3 USA/Canada compliance
The servo amplifiers on which MR-J3-D01 is mounted are designed in compliance with UL 508C and CSA C22.2 No.14.

(1) Installation
The minimum cabinet size is 150% of each MR-J4 servo amplifier's volume including MR-J3-D01. Also, design the cabinet so that the ambient temperature in the cabinet is 55 °C or less. MR-J3-D01 and servo amplifier must be installed in a metal cabinet. For environment, the units should be used in open type (UL 50) and overvoltage category III or lower. MR-J3-D01 and servo amplifier needs to be installed at or below of pollution degree 2. For connection, use only copper wires.

(2) Short-circuit current rating (SCCR)
Each servo amplifier on which MR-J3-D01 is mounted has checked with a short-circuit test.

(3) Overload protection characteristics
The servo amplifier on which MR-J3-D01 is mounted has servo motor overload protective function. (It is set on the basis (full load current) of 120% rated current of the servo amplifier.)

(4) Over-temperature protection for motor
Motor Over temperature sensing is not provided by the drive. Integral thermal protection(s) is necessary for motor and refer to chapter 4 for the proper connection.

(5) Capacitor discharge
It takes 15 minutes for capacitor discharging of the servo amplifier on which MR-J3-D01 is mounted. Do not touch the unit and terminals immediately after power off.

(6) Branch circuit protection
For installation in United States, branch circuit protection must be provided, in accordance with the National Electrical Code and any applicable local codes. For installation in Canada, branch circuit protection must be provided, in accordance with the Canada Electrical Code and any applicable provincial codes.

2.2.4 South Korea compliance
This product complies with the Radio Wave Law (KC mark). Please note the following to use the product. 이 기기는 업무용 (A급) 전자파적합기로서 판 매자 또는 사용자는 이 점을 주의하시기 바라며, 가정용의 지역에서 사용하는 것을 목적으로 합니다. (The product is for business use (Class A) and meets the electromagnetic compatibility requirements. The seller and the user must note the above point, and use the product in a place except for home. In addition, use a ferrite core and line noise filter for inputs and outputs.)

2.3 General cautions for safety protection and protective measures
Observe the following items to ensure proper use of the servo amplifiers on which MR-J3-D01 is mounted.

- Only qualified personnel and professional engineers should perform system installation.
- When mounting, installing, and using them, always observe standards and directives applicable in the country.
- They fulfill the requirements to conducted emissions at the main connections in the frequency range from 150 kHz to 30 MHz. (Bases for the evaluation: Product standard IEC/EN 61800, adjustable speed electrical power drive systems, Part 3: EMC)

2.4 Disposal
Disposal of unusable or irreparable devices should always occur in accordance with the applicable country-specific waste disposal regulations. (Example: European Waste 16 02 14)

3. Mounting/dismounting

CAUTION ●The devices must be installed in the specified direction. Not doing so may cause a malfunction.
●Mount the servo amplifier on a cabinet which meets IP54 in the correct vertical direction to maintain pollution degree 2.

The following shows an example of mounting procedures of a 200 V class 100 W servo amplifier. For details of other servo amplifiers, refer to each instruction manual or specification of the servo amplifiers on which MR-J3-D01 is mounted.

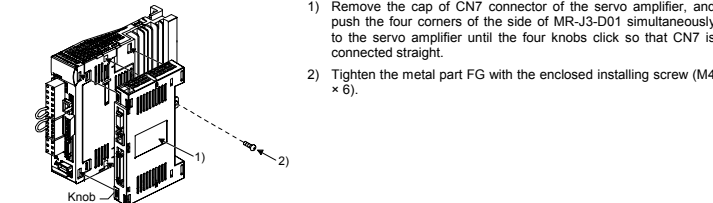

- Remove the cap of CN7 connector of the servo amplifier, and push the four corners of the side of MR-J3-D01 simultaneously to the servo amplifier until the four knobs click so that CN7 is connected straight.
- Tighten the metal part FG with the enclosed installing screw (M4 x 6).

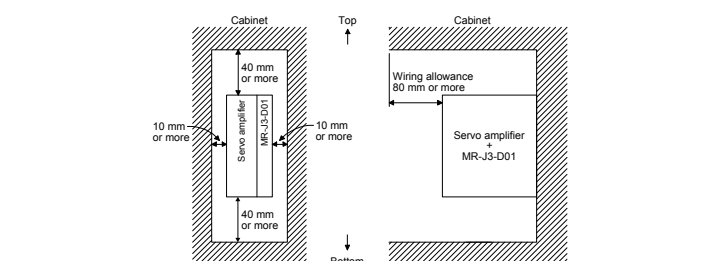

4. Electrical Installation and configuration diagram

WARNING ●Turn off the molded-case circuit breaker (MCCB) to avoid electrical shocks or damages to the product before starting the installation or wiring.

The following shows a representative configuration example. The control circuit connectors described by rectangles are safely separated from the main circuits described by circles. For 3-phase 230 V AC input

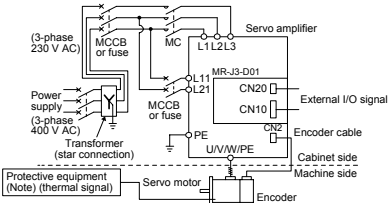

Note. Please use a thermal sensor, etc. for thermal protection of the servo motor.

5. Maintenance and service

This chapter explains servo amplifiers on which MR-J3-D01 is mounted.

WARNING ●To avoid an electric shock, only qualified personnel should attempt inspections. For repair and parts replacement, contact your local sales office.

5.1 Inspection items
It is recommended that the following points periodically be checked.

- Check for loose terminal screws of the servo amplifier. Retighten any loose screws.
- Check servo motor bearings, brake section, etc. for unusual noise.
- Check the cables and the like for scratches or cracks. Perform periodic inspection according to operating conditions.
- Check that the connectors are securely connected to the servo motor.
- Check that the wires are not coming out from the connector.
- Check for dust accumulation on the servo amplifier.
- Check for unusual noise generated from the servo amplifier.
- Check the servo motor shaft and coupling for connection.

5.2 Parts having service lives
MR-J3-D01 has no parts for replacement.

6. Transportation and storage

CAUTION ●Transport the products correctly according to their mass.
●Stacking in excess of the limited number of product packages is not allowed.
●Install the equipment in a load-bearing place in accordance with each instruction manual or specification of the servo amplifiers on which MR-J3-D01 is mounted.
●Do not get on or put heavy load on the equipment.

When you keep or use it, please fulfill the following environment.

Item	Environment
Ambient temperature	Operation °C 0 to 55 Class 3K4 (IEC/EN 60721-3-3)
	Transportation (Note) °C -20 to 65 Class 2K4 (IEC/EN 60721-3-2)
	Storage (Note) °C -20 to 65 Class 1K4 (IEC/EN 60721-3-1)
Ambient humidity	Operation, transportation, storage 5% to 90 %RH
	Test condition 10 Hz to 57 Hz with amplitude of 0.075 mm 57 Hz to 150 Hz with constant acceleration of 9.8 m/s ² to IEC/EN 61800-5-1 (Test Fc of IEC 60068-2-6)
Vibration resistance	Operation 5.9 m/s ²
	Transportation (Note) Class 2M3 (IEC/EN 60721-3-2)
	Storage Class 1M2 (IEC/EN 60721-3-2)
Pollution degree	2
IP rating	Mounted on a servo amplifier: IP20 (IEC/EN 60529)
	MR-J3-D01 (single): IP00 (IEC/EN 60529)
Altitude	Open type (UL 50) 1000 m or less above sea level
	Transportation 10000 m or less above sea level

Note. In regular transport packaging

7. Technical data

7.1 MR-J3-D01

Item	Description
Model	MR-J3-D01
Function	Additional digital input/output, additional analog input/output, external digital display connection
Digital input	Photocoupler insulator 24 V DC (external supply) Sink/source compatible, internal limit resistor: 5.6 kΩ
Digital output	16 points, photocoupler insulator, open collector 24 V DC (external supply) Sink/source compatible, permissible current: 40 mA or less, inrush current: 100 mA or less
Analog input	2 channel input voltage: -10 V to +10 V DC, internal resistor: 12 kΩ, resolution: 12 bits
Analog output	2 channel input voltage: -12 V to +12 V DC, maximum output current: 1 mA, resolution: 12 bits
+15 V output for analog input signal	Available as analog input signal power supply Output voltage: +15 V, permissible current: 30 mA
Accessory	Fixing screw (M4) x 1
Mass	140

7.2 Dimensions

